

HAMMER  
TACKERS

MANUAL  
STAPLERS

HOG RING  
PLIERS

**EVERWIN**

TOUGHER.

FASTER.

SMARTER.



### FEATURES:

- All Steel Construction
- Anti-rust Chrome-plated
- Rear Loading Magazine
- Quick Jam Clearing
- Ergonomic Handle Grip

### APPLICATIONS:

- Carpeting
- Insulation
- Roofing
- Tar Paper
- Poly Sheeting



### EW-101 Top Load

**Magazine capacity: 84 pcs (1 strip)**

Packaging:

- Sliding blister
- Master carton: 10 pcs
- Pallet: 600 pcs

### Staple Specification:

- Wire gauge: 20 Ga.
- Crown width: 10.6 mm
- Wire size: 0.5 x 1.25 mm
- Staple sizes: 6, 8, 10 mm (1/4" - 3/8")

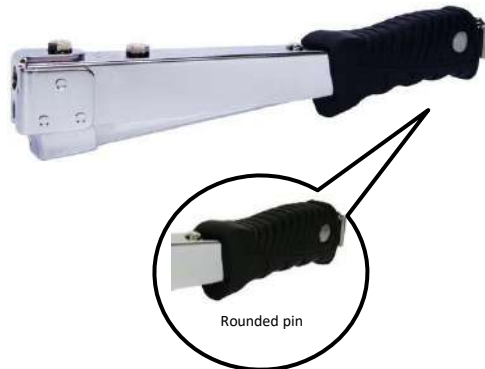
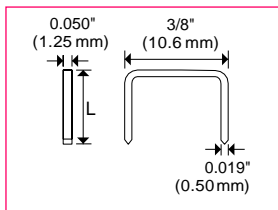

### EW-11 Rear Load

**Plastic grip with flat pin**

**Magazine capacity: 168 pcs (2 strips)**

Packaging:

- Sliding blister
- Master carton: 10 pcs
- Pallet: 600 pcs

### Compatible with:

- A-11
- Arrow® T-50
- Rapid® 140
- Black & Decker 6000E
- Bostitch TRA700
- Senco H
- Bostitch TRA700
- Wolfcraft 056

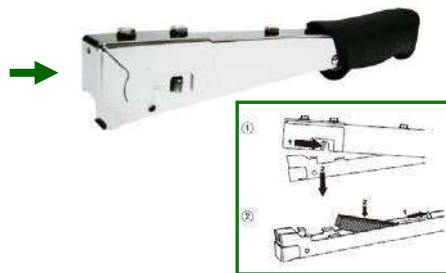

### EW-10 Top Load

**Magazine capacity: 84 pcs (1 strip)**

Packaging:

- Sliding blister
- Master carton: 10 pcs
- Pallet: 750 pcs

Model No.	Tool Specification				Staple Specification		
	Finish	Dimensions (L x W x H)	Tool Weight	Magazine Capacity	Crown (mm)	Wire (mm)	Staple Size (mm)
EW-101	Chromed	30.5 x 8.7 x 4 cm	0.63 kgs (1.4 lbs)	84 pcs (1 strip)	3/8" (10.5)	20 GA (0.5 x 1.25)	1/4", 5/16", 3/8" (6, 8, 10 mm)
EW-11	Chromed	30.5 x 5.6 x 4 cm	0.9 kgs (2.0 lbs)	168 pcs (2 strips)	3/8" (10.5)	20 GA (0.5 x 1.25)	1/4", 5/16", 3/8" (6, 8, 10 mm)
EW-10	Chromed	27.3 x 4.5 x 3 cm	0.46 kgs (1.0 lbs)	84 pcs (1 strip)	3/8" (10.5)	20 GA (0.5 x 1.25)	1/4", 5/16", 3/8" (6, 8, 10 mm)



## INDUSTRIAL GRADE T-50 HAMMER TACKERS (8~14mm)

### FEATURES:

- All Steel Construction
- Anti-Rust Chrome-Plated
- Rear Loading Magazine
- Quick Jam Clearing
- Ergonomic Handle Grip

### APPLICATIONS:

- Carpeting
- Insulation
- Roofing
- Tar Paper
- Poly Sheeting

### Staple Specification:

- Wire gauge: 20 Ga.
- Crown width: 10.6 mm
- Wire size: 0.5 x 1.25 mm
- Staple sizes: 8 - 14 mm (5/16" - 9/16")

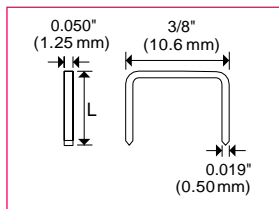

### EW-50BL Bottom Load

- Clamshell blister pack
- 10 pcs per carton
- 400 pcs per pallet



*Bottom Load & Flat Contact Tip*



*No-Lose Parts*

### Compatible with:

- A-11
- Arrow® T-50
- Rapid® 140
- Black & Decker 6000E
- Bostitch TRA700
- Senco H
- Stanley® TRA700
- Wolfcraft 056



### EW-50AB Rear Load

- Sliding blister pack
- 10 pcs per carton
- 400 pcs per pallet



### EW-54A Rear Load

- Sliding blister pack
- 10 pcs per carton
- 400 pcs per pallet

Model No.	Tool Specification				Staple Specification		
	Finish	Dimensions (LxWxH)	Tool Weight	Magazine Capacity	Crown (mm)	Wire (mm)	Staple Size (mm)
EW-50BL	Chromed	305 x 87 x 40 cm	1.04 kgs (2.29 lbs)	168 pcs (2 strips)	3/8" (10.5)	20 GA (0.5 x 1.25)	5/16" - 9/16" (8, 10, 12, 14 mm)
EW-50AB	Chromed	305 x 87 x 40 cm	1.07 kgs (2.35 lbs)	168 pcs (2 strips)	3/8" (10.5)	20 GA (0.5 x 1.25)	5/16" - 9/16" (8, 10, 12, 14 mm)
EW-54A	Chromed	305 x 70 x 40 cm	1.0 kgs (2.2 lbs)	168 pcs (2 strips)	3/8" (10.5)	20 GA (0.5 x 1.25)	5/16" - 9/16" (8, 10, 12, 14 mm)

**FEATURES:**

- All Steel Construction
- Anti-rust Chrome-plated
- Fast Loading Magazine
- Quick Jam Clearing
- Ergonomic Handle Grip

**APPLICATIONS:**

- Carpeting
- Insulation
- Roofing
- Tar Paper
- Poly Sheeting

**STAPLE SPECIFICATION:**

- Fine wire (22 GA)
- Staple size: 6, 8, 10 mm (1/4", 5/16" & 3/8")

**PACKAGING:**

- Blister card
- 10 pcs per carton
- 750 pcs per pallet

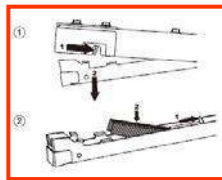

**EW-19 Top Load**

Compatible with:

- Rapid 13
- Novus 37
- A-19

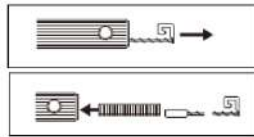
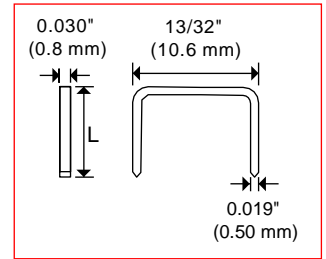

**EW-21-1 Rear Load**

Compatible with:

- Rapid 13
- Novus 37
- A-19

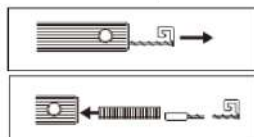
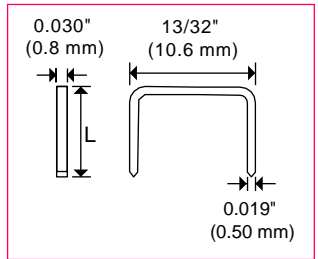

**EW-21-2 Rear Load**

Compatible with:

- Rapid 53 / Esco 530
- Arrow JT-21
- Stanley TRA200
- Rocafix N°3

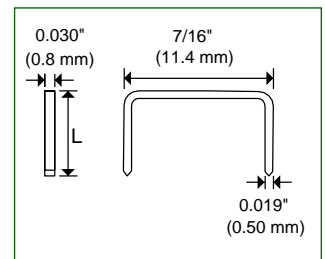

Model No.	Tool Specification				Staple Specification		
	Finish	Dimensions (LxWxH) mm	Tool Weight t	Magazine Capacity	Crown (mm)	Wire (mm)	Staple Size (mm)
EW-19	Chromed	273 x 50 x 30 mm	0.5 kgs (1.1 LBS)	156PCS (1strip)	13/32" (10.6)	22 GA (0.5 x 0.75)	1/4", 5/16", 3/8" (6, 8, 10 mm)
EW-21-1	Chromed	262 x 45 x 30 mm	0.6 kgs (1.32 LBS)	156PCS (1strip)	13/32" (10.6)	22 GA (0.5 x 0.75)	1/4", 5/16", 3/8" (6, 8, 10 mm)
EW-21-2	Chromed	262 x 45 x 30 mm	0.6 kgs (1.32 LBS)	156PCS (1strip)	7/16" (11.4)	22 GA (0.5 x 0.75)	1/4", 5/16", 3/8" (6, 8, 10 mm)



# INDUSTRIAL Duo Fast 5000 HAMMER TACKERS (6~10mm)

## FEATURES:

- All Steel Construction
- Heavy-Duty
- Ergonomic Handle Grip
- Rear Loading Magazine
- Quick Jam Clearing

## APPLICATIONS:

- Carpeting
- Insulation
- Roofing
- Tar Paper
- Poly Sheeting

## Staple Specification:

- Wire gauge: 20
- Wire size: 0.5 x 1.25 mm
- Crown width: 12.5 mm (1/2")
- Length: 6, 8, 10 mm  
(1/4", 5/16", 3/8")

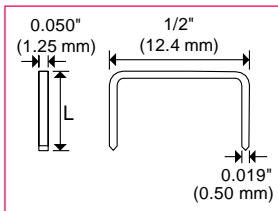

## Compatible with:

- Duo-Fast 5000
- Arrow 850
- Bea 95
- Prebena AB
- Fasco 50
- Senco D



**Flat Contact Tip**



**Bottom load**



## EW-56BL HAMMER TACKER

Staple loading: bottom load  
Magazine capacity: 168 pcs

### Packaging:

- Clamshell Blister
- Master Carton: 10 Pcs
- Pallet: 400 Pcs

## EW-10550A HAMMER TACKER

Staple loading: rear load  
Magazine capacity: 168 pcs

### Packaging:

- sliding blister
- Master carton: 10 pcs
- Pallet: 400 pcs

## EW-10550 HAMMER TACKER

Staple loading: rear load  
Magazine capacity: 168 pcs

### Packaging:

- Plain box
- Master carton: 10 pcs
- Pallet: 720 pcs

Model No.	Tool Specification				Staple Specification		
	Finish	Tool Weight	Loading Method	Magazine Capacity	Crown (mm)	Wire (mm)	Staple Length (mm)
EW-56BL	Black	1.05 kgs (2.3 LBS)	Bottom Load	168 pcs (2 stripS)	1/2" (12.5mm)	20 GA (0.5 x 1.25)	1/4" - 3/8" (6, 8, 10 mm)
EW-10550A	Black	1.1 KGS (2.4 LBS)	Rear Load	168 pcs (2 stripS)			1/4" - 3/8" (6, 8, 10 mm)
EW-10550	Black	0.9 kgs (2.0 LBS)	Rear Load	168 pcs (2 stripS)			1/4" - 3/8" (6, 8, 10 mm)



# INDUSTRIAL Duo Fast 7500 HAMMER TACKERS (6~14mm)

### FEATURES:

- All Steel Construction
- Light Weight
- Comfort Rubber Grip

### APPLICATIONS:

- Carpet Padding
- Insulation
- Roofing Paper
- House Wrap
- Poly Sheeting

### Staple Specification:

- Crown: 15/32" (11.9 mm)
- Wire: 0.5 x 1.25 mm (19GA)
- Magazine Capacity: 168pcs (2 full sticks)

### Packaging:

- Master carton: 10 pcs
- Pallet: 400 pcs



**EW-14755**

Drives Duo-Fast 7500 & STCR5019 staples:  
8, 10, 12, 14 mm (5/16" to 9/16")  
Tool weight: 1.17 kg (2.6 lbs)  
Finish: black painted  
Packaging: plain box



**EW-14755A**

Drives Duo-Fast 7500 & STCR5019 staples:  
8, 10, 12, 14 mm (5/16" to 9/16")  
Tool weight: 1.17 kg (2.6 lbs)  
Finish: black painted  
Packaging: sliding blister



**EW-10755**

Drives Duo-Fast 7500 staples:  
6, 8, 10 mm (1/4", 5/16", 3/8")  
Tool weight: 0.9 kg (1.8 lbs)  
Finish: chrome-plated  
Packaging: plain box



**EW-75BL**

Drives Duo-Fast 7500 staples:  
8, 10, 12, 14 mm (5/16" to 9/16")  
Tool weight: 1 kg (2.2 lbs)  
Finish: chrome-plated with black cover  
Packaging: clamshell blister

Model No.	Staple Specification	Compatible Staples	Staple size (mm)	Crown (mm)	Wire (mm)	Magazine Capacity	Staple Load
EW-14755		<ul style="list-style-type: none"> <li>•Duo-Fast 7500</li> <li>•Bostitch STCR5019</li> </ul>	5/16"-9/16" (8,10,12, 14)	15/32" (11.90)	19 GA (0.5 x 1.25)	168 PCS (2 strips)	Rear Load
EW-14755A							Rear Load
EW-10755		Duo-Fast 7512 series	1/4"-3/8" (6, 8, 10)				Rear Load
EW-75BL		Duo-Fast 7500 series	5/16"-9/16" (8,10,12,14)				Bottom Load

## INDUSTRIAL GRADE STCR Series HAMMER TACKERS (6~10mm)

### FEATURES:

- All Steel Construction
- Light Weight
- Nimble Housing
- Ergonomic Rubber Grip

### APPLICATIONS:

- Carpet padding
- Insulation
- Roofing paper
- House wrap
- Poly sheeting

### Staple Specification:

- STCR5019 type staples  
crown: 11.7 mm
- STCR2619 type staples  
crown: 11.5 mm

### EW-5019 uses STCR5019 type staples

#### Tool description:

- Mustard body & chrome-plated magazine
- Staple Capacity: 168pcs (2 full sticks)
- Tool weight: 0.9 kg (2 lbs)

#### Packaging:

- Paper box
- Master carton: 20 pcs
- Pallet: 720 pcs

### EW-2619 uses STCR2619 type staples

#### Tool description:

- Mustard body & chrome-plate magazine
- Staple Capacity: 156 pcs
- Tool weight: 0.6 kg (1.4 lbs)

#### Packaging:

- Blister card
- Master carton: 10 pcs
- Pallet: 720 pcs

Model No.	Staple Specification	Compatible Staples	Crown (mm)	Wire (mm)	Magazine Capacity	Finish	Staple Load
EW-5019		STCR5019-1/4 STCR5019-/16 STCR5019-3/8	7/16" (11.7 mm)	20 GA (0.5 x 1.25)	168 pcs (2 strips)	Mustard painted	Rear Load
EW-2619		STCR2619-1/4 STCR2619-/16 STCR2619-3/8	7/16" (11.5 mm)	22GA (0.5 x 0.65)	156 pcs (1 strip)	Mustard painted	Rear Load



# MANUAL STAPLERS (6~14mm)

**FEATURES:**

- All Steel Construction
- Rear Loading Magazine
- Quick Jam Clearing
- Ergonomic Handle
- Safety Handle Lock

**APPLICATIONS:**

- Carpeting
- Insulation
- Roofing
- House Wrap
- Poly Sheeting

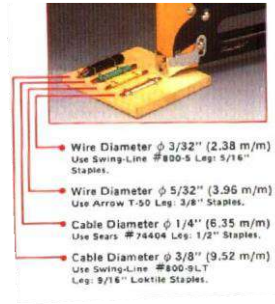

**EWL-1** drives **A-11 & T-50 & R140** type staples

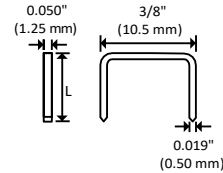

**EWL-33** drives **A-19, R13, R53 & Max T3** type staples

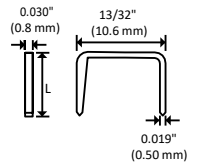

**EWL-5019** drives **BOSTITCH STCR5019** staples

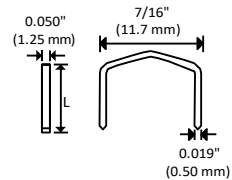

**EWL-50** drives **DUO-FAST 5000** type staples

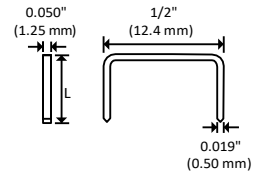

**EWL-80** drives **Bea 80** type staples.

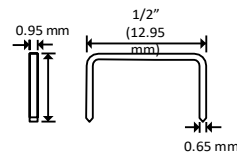

Model No.	Tool Specification			Staple Specification			
	Finish	Tool Weight	Capacity	Compatible Staples	Crown	Gauge	Wire (mm)
EWL-1	RED COVER wire attachment	1.0 kgs (2.2 lbs)	84 pcs (1strip)	A-11; T-50; R 140	10.6 mm (3/8")	20	0.50x1.25
EWL-33	YELLOW COVER	0.85 kgs (1.88 lbs)	126 pcs (1strip)	A19; R 13 R53; JT-21 Max T3	10.5 & 11.4 mm (13/32" & 7/16")	23	0.50x0.70
EWL-5019	BLACK COVER	0.85 kgs (1.88 lbs)	84 pcs (1 strip)	Bostitch STCR5019	11.6mm(7/16")	20	0.50x1.25
EWL-50	GREEN COVER	0.85 kgs (1.88 lbs)	84 pcs (1 strip)	Duo-Fast 5000 SERIES	12.5 mm (1/2")	20	0.50x1.25
EWL-80	CHROMED COVER	0.85 kgs (1.88 lbs)	84 pcs (1 strip)	BEA 80	12.7 mm (1/2")	21	0.65x0.95

HAMMER TACKERS - MANUAL STAPLERS - HOG RING PLIERS



**Features:**

- All Steel Construction
- Bottom Load
- Slip-Free Handle
- Easy Squeeze
- Quick Jam Clearing
- Safety Handle Lock

**Applications:**

- Carpeting
- Insulation
- Roofing
- House wrap
- Poly sheeting

**Tool Description:**

- Weight: 1 Kg (2.2 lbs)
- Finish: Anti-Rust Chrome-Plated
- Magazine Capacity: 168 Pcs

**Drives T50 type staples in:**

- 8 mm – 5/16"
- 10 mm – 3/8"
- 12 mm – 1/2"
- 14 mm – 9/16"



Bottom load



Model No.	Staple Specification	Compatible Staples	Load Capacity	Finish
EWT-T50		<ul style="list-style-type: none"> <li>• Arrow® T-50</li> <li>• Rapid® 140</li> <li>• Stanley® TRA700</li> <li>• Senco H</li> <li>• Novus 11</li> <li>• Knoll 11</li> <li>• A-11</li> </ul>	100 pcs	Chrome-plated *Handle red

**Features:**

- All Steel Construction
- Anti-Rust Chrome-Plated
- Ergonomic Slip-Free Handle
- Quick Jam Clearing
- Easy Load

**Applications:**

- Carpeting
- Insulation
- Roofing
- House wrap
- Poly sheeting

**Staple Specification:**

- Wire gauge: 23 Ga.
- Crown width: 12.9 mm
- Wire size: 0.55 x 0.8 mm



**EW-58 Light Staple Gun Tacker**

- Staple length: 6, 8, 10 mm (1/4" to 3/8")
- Magazine capacity: 160 pcs
- Loading: Bottom load



**EWT-M3 Heavy Staple Gun Tacker**

- Staple length: 6, 8, 10, 12, 14 mm (1/4" to 9/16")
- Magazine capacity: 160 pcs
- Loading: Bottom load



**EW-101M Hammer Tacker**

- Staple length: 6, 8, 10 mm (1/4" to 3/8")
- Magazine capacity: 160 pcs
- Loading: Top load

Model No.	Compatible Staples	Staple Specification	Magazine Capacity	Finish
EWT-M3	<ul style="list-style-type: none"> <li>• Max T3</li> <li>• Novus24</li> <li>• Rapid958</li> <li>• Esco 580</li> </ul>		160	Chrome-plated
EW-58			160	Chrome-plated
EW-101M			100	Chrome-plated

### Features:

- All Steel Construction
- Anti-Rust Finish
- Chrome-Plated
- Ergonomic Handle Grip
- Rear Loading Magazine
- Quick Jam Clearing



### Applications:

- Boatbuilding
- Casket Lining
- Furniture
- Fiberglass Lay-Up
- Insulating
- Lumber Wrap
- Metal Detectors
- Tagging
- Upholstery

### EW-11PH Hammer Tacker for heavy plastic staples

#### Tool description:

- Anti-rust chrome-plated, Rear load
- Staple size: 6-10 mm (1/4" – 3/8")

#### Package:

- Plain box; 20 pcs/carton
- 720 pcs/pallet

### EW-11P Hammer Tacker for light plastic staples

#### Tool description:

- Anti-rust chrome-plated, Rear load
- Staple size: 6-10 mm (1/4"-3/8")

#### Packaging:

- Plain box; 20 pcs/carton
- 720 pcs/pallet

### EWL- P H/D Staple Gun tacker for light plastic staples

#### Tool description:

- Rear load
- Safety handle lock
- Staple size: 6-14 mm (1/4" -9/16")

#### Packaging:

- Plain box, 10 pcs/carton
- 720 pcs/pallet

### EW-23P L/D Staple Gun tacker for light plastic staples

#### Tool description:

- Bottom load
- Safety handle lock
- Staple size: 6-10 mm (1/4"-3/8")

#### Packaging:

- Plain box; 10 pcs/carton
- 720 pcs/pallet

Model No.	Tool Specification		Staple Specification			
	Weight (kg)	Magazine Capacity	Available Staples	Crown (mm)	Wire	Staple Length
EW-11P	0.9	70	S05 & 81P	1/2" (13 mm)	19 GA	6, 8, 10 mm
EW-11PH	0.9	60	SH05 & 82P	1/2" (13 mm)	16 GA	6, 8, 10 mm
EWL-P	0.85	70	S05 & 81P	1/2"(13 mm)	19 GA	6, 8, 10, 12, 14 mm
EW-23P	0.6	70	S05 & 81P	1/2" (13 mm)	19 GA	6, 8, 10 mm



Bottom load

### FEATURES:

- All-steel construction
- Anti-rust chrome-plated
- Bottom loading magazine
- Quick jam clearing
- One-hand operation
- Ergonomic handle grip
- Safety handle lock
- Drives staples 6, 8, 10mm (1/4", 5/16", 3/8")

### APPLICATIONS:

- Carpeting
- Insulation
- Roofing
- House wrap
- Poly sheeting
- Craft

### PACKAGING:

- Clamshell pack
- 10 pcs a master carton
- 600 pcs a pallet

Model No.	Staple Size	Compatible Staples	Crown (Mm)	Wire (Mm)	Magazine Capacity	Finish	Staple Load
EW-14		A-11 ARROW T-50 TRA700 RAPID140 SENCO H	3/8" (10.6 mm)	20 GA (0.5 x 1.25)	84 pcs (1 strip)	Chromed	Bottom Load
EW-23-1		A-19 RAPID 13 Novus 37 Omer 113	15/32" (10.6 mm)	22 GA (0.5 x 0.8)	160 pcs (1 strip)	Chromed	Bottom Load
EW-23-2		Arrow JT-21 Rapid 53 TRA200 Rocafix N°3	3/8" (11.4 mm)	22 GA (0.5 x 0.8)	160 pcs (1 strip)	Chromed	Bottom Load
EW-58		Rapid 958 Esco 580 Max T3	0.512" (13 mm)	22GA (0.6 x 0.8)	160 pcs (1 strip)	Chromed	Bottom Load



## MANUAL C-RINGER / D-RINGER

### APPLICATIONS:

- Cage Construction
- Crafts
- Fastening Tensioning Wire
- Insulation Blankets
- Netting
- Pot Tagging

### FEATURES:

- All Steel Construction
- Spring-Fed Automatic Pusher
- One-Hand Operation
- Slip-Free Handle
- Chrome-Plated Magazine
- Magazine Capacity: 50 Rings



### MDR-SR15R D-Ring Plier

#### PERFORMANCE IN 2 WAYS:

- STOPPER FOR RIGHT ANGLED MAGAZINE
- ROTATABLE MAGAZINE FEED

Drives SR15, HR22, CL22 D-rings

#### PACKAGING:

- UNIT PACK: PAPER BOX
- MASTER CARTON: 12PCS
- PALLET: 216 PCS

### MDR-SR15 D-Ring Plier

compatible with SR15, HR22, CL22 D-rings

#### PACKAGING:

- UNIT PACK: PAPER BOX
- MASTER CARTON: 25 PCS
- PALLET: 1200 PCS



### MHR-7 Hog Ring Plier

compatible with SR8, 616G50 C-rings

#### PACKAGING:

- UNIT PACK: PAPER BOX
- CARTON: 25 PCS
- PALLET: 1200 PCS

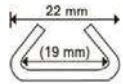

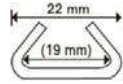
Model No.	Tool Specification		Ring Specification				
	Tool Weight	Magazine Capacity	Ring Type	Wire Ga.	Open Size	Closure Size	Compatible Ring Type
MDR-SR15R	0.6 KG (1.32 LBS)	50	D-RINGS 	15	22 mm (3/4")	7 mm (5/16")	•HR22 •CL22 •SR15
MHR-7	0.4 KG (0.9 LBS)	50	C-RINGS 	16	19.5 mm (11/16")	7-9 mm (9/32")	•SR8 •616G50 •616SS50
MDR-SR15	0.5 KG (1.1 LBS)	50	D-RINGS 	15	22 mm (3/4")	7 mm (5/16")	•HR22 •CL22 •SR15

A construction worker with a beard and safety glasses is using an Everwin nail gun on a wooden frame. The image has a red tint. The text is overlaid on the image.

The  
**DURABILITY**  
You Know  
—  
With Unexpected  
**INNOVATION**

**EVERWIN**

[www.everwinpneumatic.com](http://www.everwinpneumatic.com)  
[sales@everwinpneumatic.com](mailto:sales@everwinpneumatic.com)